



**HUNTERS<sup>®</sup>**  
HERE TO GET *you* THERE

Chobham Road, Stratford, E15, London, E15 1LU | Guide Price: £290,000 - £320,000  
Call us today on 0207 474 2345





Score	Energy rating	Current	Potential
92+	A		
81-91	B		
69-80	C	76   c	80   c
55-68	D		
39-54	E		
21-38	F		
1-20	G		

### Thinking of Selling?

If you are thinking of selling your home or just curious to discover the value of your property, Hunters would be pleased to provide free, no obligation sales and marketing advice. Even if your home is outside the area covered by our local offices we can arrange a Market Appraisal through our national network of Hunters estate agents.

**Guide Price: £290,000 - £320,000**

**Located in a tree-lined residential road in Stratford is this first floor purpose built flat. The property boast two double bedrooms, lounge, kitchen and bathroom. Situated within easy reach of local amenities and Westfield Shopping Centre, where you will find an array of shops, bars and eateries, along with the luscious green of the Olympic Park. There are many bus link available and Stratford International is within close proximity offering routes into the City.**

#### **LOUNGE**

**12'9" x 11'10"**

Double glazed windows, wall mounted gas central heating.

#### **KITCHEN**

**10'4" x 6'6"**

Double glazed window, range of wall and base units, roll top work surface, sink and drainer, oven and hob with extractor above, tiled splash backs.

#### **BATHROOM**

Double glazed frosted window, three piece suite comprising of panelled bath with shower attachment, low level w.c, wash hand basin, wall mounted gas central heating, tiled walls.

#### **BEDROOM ONE**

**13'8" x 10'6"**

Double glazed windows, wall mounted gas central heating.

#### **BEDROOM TWO**

**11'10" x 8'1"**

Double glazed window, wall mounted gas central heating.

## GROUND FLOOR

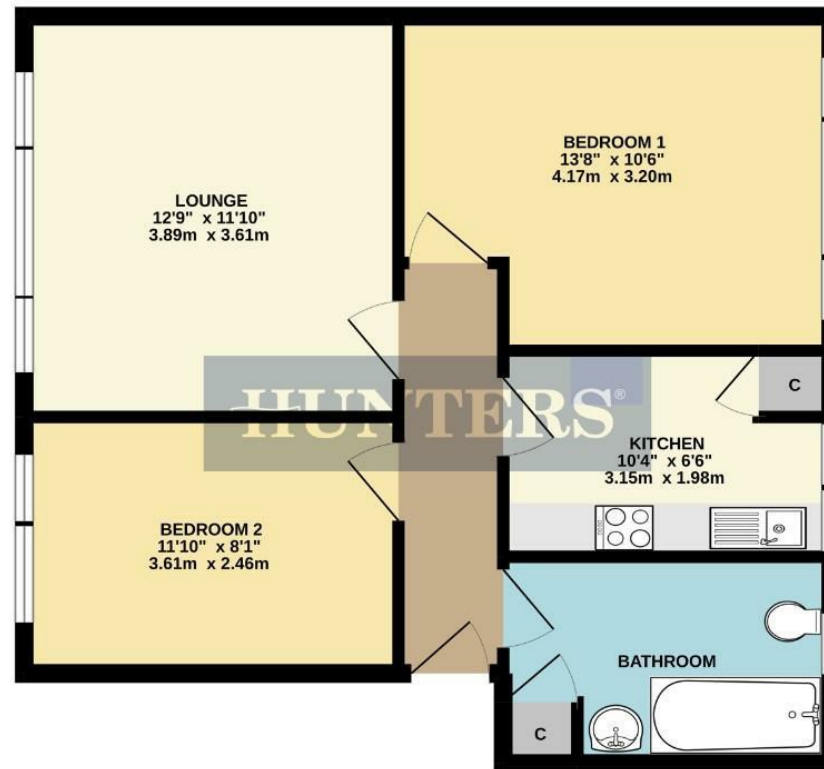

Whilst every attempt has been made to ensure the accuracy of the floorplan contained here, measurements of doors, windows, rooms and any other items are approximate and no responsibility is taken for any error, omission or mis-statement. This plan is for illustrative purposes only and should be used as such by any prospective purchaser. The services, systems and appliances shown have not been tested and no guarantee as to their operability or efficiency can be given.  
Made with Metropix ©2022

These particulars are intended to give a fair and reliable description of the property but no responsibility for any inaccuracy or error can be accepted and do not constitute an offer or contract. We have not tested any services or appliances (including central heating if fitted) referred to in these particulars and the purchasers are advised to satisfy themselves as to the working order and condition. If a property is unoccupied at any time there may be reconnection charges for any switched off/disconnected or drained services or appliances - All measurements are approximate.

272 Barking Road, Plaistow, E13 8HR | 0207 474 2345 | [plaistow@hunters.com](mailto:plaistow@hunters.com)

**HUNTERS®**  
HERE TO GET *you* THERE